

**Cepex panel mounted receptacle SCHUKO®**

Part no. 4979



- alpine white or pearl white
- screw terminals
- suitable for installation in cable ducts and columns
- meeting DIN 18032 standards for ball rebound

**Technical specifications**

Ampere	16 A
Poles	2 p+PE
Voltage	230 V
Hertz	50-60 Hz
Protection type	IP44
Shutter	false
Weight	137 g

**Drawing**

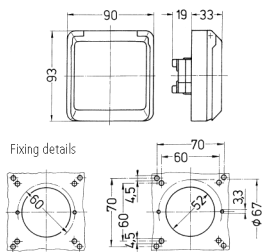

Drawing  
1 MB 304  
Dim. in mm