

**Cepex panel mounted receptacle SCHUKO®**

Part no. 4977



- screw terminals
- with labelling field
- with safety lock
- two keys
- cannot be dismantled when locked
- on request with identical locks
- suitable for installation in cable ducts and columns
- with identical lock: part no + index G

**Technical specifications**

Ampere	16 A
Poles	2 p+PE
Voltage	230 V
Hertz	60-50 Hz
Protection type	IP44
Shutter	false
Weight	167 g

**Drawing**

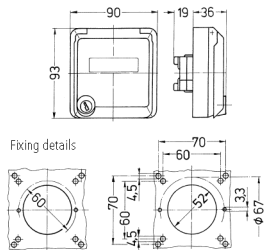

Drawing  
1 MB 305  
Dim. in mm