

Wall mounted receptacle with TwinCONTACT

Part no. 1756



- screwless spring terminals
- suitable for through wiring
- internal fixing
- enclosure base can be turned 180°
- receptacles are designed for adding an auxiliary contact switch

Technical specifications

Ampere	16 A
Poles	5 p
Voltage	230 V
Clock position	9 h
Hertz	50-60 Hz
Connection technology	Screwless - TwinCONTACT
Contact	standard
Protection type	IP44
Weight	288 g

Drawing

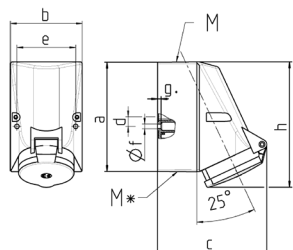

Drawing	Amp.	16		32					
		Poles		4	5	3	4	5	
1 MB 43									
Dim. in mm									
a		128	128	128	128	128			
b		84	84	84	84	84			
c		122	124	136	136	138			
d		11	11	11	11	11			
e		68	68	68	68	68			
f		5.3	5.3	5.3	5.3	5.3			
g		4	4	4	4	4			
h		144	145	158	158	160			
M		25	25	32	32	32			
M*		2x25 (blind) to be cut out		2x25 (blind) to be cut out					
Max. cable diam. (mm)		18	18	18/25	18/25	18/25			
Terminal for cond. cross section (mm ²) min.-max.		1.5	1.5	2.5	2.5	2.5			
		-4	-4	-10	-10	-10			