

## Panel mounted inlet

Part no. 392



- screw terminals
- with hinged lid

## Technical specifications

|                       |                 |
|-----------------------|-----------------|
| Ampere                | 16 A            |
| Poles                 | 4 p             |
| Voltage               | 110 V           |
| Clock position        | 4 h             |
| Hertz                 | 50-60 Hz        |
| Connection technology | Screw terminals |
| Contact               | standard        |
| Protection type       | IP44            |
| Weight                | 260 g           |

## Drawing

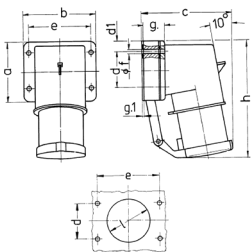

| Drawing<br>2 MB 43 | Amp.<br>Poles   | 16   |      | 32  |     |     |
|--------------------|---|------|------|-----|-----|-----|
|                    |   | 4    | 5    | 3   | 4   | 5   |
| Dim. in mm         | a   | 85   | 85   | 75  | 75  | 75  |
|                    | b   | 85   | 85   | 90  | 90  | 90  |
|                    | c   | 104  | 106  | 115 | 115 | 117 |
|                    | d   | 64   | 64   | 45  | 45  | 45  |
|                    | d1  | 10   | 10   | 13  | 13  | 13  |
|                    | e   | 64   | 64   | 78  | 78  | 78  |
|                    | f   | 5.5  | 5.5  | 5.5 | 5.5 | 5.5 |
|                    | g   | 27   | 27   | 27  | 27  | 27  |
|                    | g-1   | 2    | 2    | 1   | 1   | 1   |
|                    | h   | 140  | 140  | 150 | 150 | 150 |
|                    | l   | 50   | 50   | 55  | 55  | 55  |
|                    | Terminal for cond. cross section (mm <sup>2</sup> ) min.-max. | 1    | 1    | 2.5 | 2.5 | 2.5 |
|                    |   | -2.5 | -2.5 | -6  | -6  | -6  |