



HID-HighPower for SON/MH/HPL/HPI

BHD 2000 L76 380/400/415V 50Hz HP-317

Encapsulated ballasts for use with SON (T) (Plus), HPL, HPI and MH lamps with rated wattages of 1000 W and above

Product data

General information		Wiring	
Remarks	UK importer address: Signify Commercial UK Limited, 3, Guildford Business Park, GU2 8XG	Wire strip length	7.0 mm
Application code	L76-A2	Ballast contact wire cross section	0.70–6.00 mm ²
Design	HP-317	Connector type	Screw
Lamp type	MH	System characteristics	
Number of lamps	1 piece/unit	Capacitor	75µF/450V
Operating and electrical		Rated ballast-lamp power	2000 W
Input Voltage	380 to 415 V	Recommended ignitor	Series ignitor
Input frequency	50 Hz	Temperature	
Input voltage (multi-tab)	380/400/415	T storage (max.)	80 °C
Power factor 100% load (nom.)	0.87	T storage (min.)	-25 °C
Mains voltage performance (AC)	-8%–+6%	T-winding (max.)	130 °C
Mains voltage safety (AC)	-10%–+10%	Delta-T normal conditions	65 °C
Input current with PF correction	6.60 A	Approval and application	
Input current without PF Correction	11.30 A	Approval marks	CE marking ENEC certificate
Power factor without PF compensation (nom.)	0.50	Product data	
Power losses (nom.)	80.0 W	Full product code	871150074276600

HID-HighPower for SON/MH/HPL/HPI

Order product name	BHD 2000 L76-A2 380/400/415V 50Hz HP-317
EAN/UPC – product	8711500996695
Order code	74276600
Local order code	BHD2000L76
SAP numerator – quantity per pack	1

Numerator – packs per outer box	1
SAP material	913700232103
Net Weight (Piece)	17.500 kg

Dimensional drawing

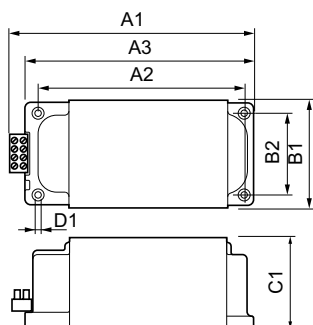

BHD 2000 L76-A2 380/400/415V 50Hz HP-317

Product	D1	C1	A1	A2	A3	B1	B2
BHD 2000 L76-A2 380/400/415V 50Hz HP-317	6.5 mm	102.0 mm	317.0 mm	282.0 mm	306.0 mm	117.0 mm	88.0 mm

