



CoreLine Projector gen2

ST151T LED30S/930 WB BK

- 38 degree(s) - 930 warm white - Power supply unit

The well-known CoreLine Projector with its latest generation has undergone important design and performance improvement, raising the bar even higher and setting a new standard for track projectors used in retail and hospitality applications.

Warnings and Safety

- The luminaire should be mounted outside of arm's reach
- The luminaire should be installed by a qualified electrician and wired in accordance with the latest IEE electrical regulations or the national requirements

Product data

Operating and electrical			
Input Voltage	220 to 240 V	Light source replaceable	No
Line Frequency	50 or 60 Hz	Number of gear units	Unit
Input frequency	50 or 60 Hz	Driver/power unit/transformer	Power supply unit
Initial CLO power consumption	30 W	Driver included	Yes
Average CLO power consumption	30 W	Optic type	Beam angle 38°
Power Consumption	30 W	Luminaire light beam spread	38°
Inrush current	43.8 A	Control interface	-
Inrush time	0.0115 ms	Connection	Track
Power Factor (Fraction)	0.9	Cable	-
		Protection class IEC	Safety class I
		Glow-wire test	Temperature 650 °C, duration 30 s
		Flammability mark	-
		CE mark	Yes
		ENEC mark	ENEC mark
General information			
Beam angle of light source	38 degree(s)		
Light source colour	930 warm white		

CoreLine Projector gen2

Warranty period	5 years
Constant light output	Yes
Number of products on MCB of 16 A type B	30
Photobiological risk	Photobiological risk group 0 @200mm to EN62778
Photobiological risk specification	0.2 m
EU RoHS compliant	Yes
Unified Glare Rating (CEN)	19
Lighting Technology	LED
Brand	Philips
Value ladder	Value

Light technical

Luminous Flux	3,000 lm
Saturated Red (R9)	>50
Luminous Efficacy (rated) (Nom)	100 lm/W
Colour rendering index (CRI)	>90

Temperature

Ambient temperature range	-20 to +40 °C
---------------------------	---------------

Mechanical and housing

Housing material	Aluminium
Reflector material	-
Optic material	Polycarbonate
Optical cover/lens material	Polycarbonate
Fixation material	-
Housing Colour	Black
Optical cover/lens finish	-
Overall length	207 mm
Overall width	87 mm
Overall height	125 mm
Overall diameter	80 mm
Dimensions (height x width x depth)	NaN x NaN x NaN mm

Approval and application

Ingress protection code	IP20 [Finger-protected]
Mech. impact protection code	IK03 [0.3 J]
Sustainability rating	-

Initial performance (IEC compliant)

Luminous flux tolerance	+/-10%
Init. Corr. Colour Temperature	3000 K
Initial chromaticity	(0.4355, 0.4045) SDCM <4
Power consumption tolerance	+/-10%

Over time performance (IEC compliant)

Control gear failure rate at median useful life	0.05 %
50,000 h	
Lumen maintenance at median useful life*	L70
50,000 h	

Application conditions

Performance ambient temperature Tq	25 °C
Maximum dim level	Not applicable
Suitable for random switching	No

Product data

Full EOC	871951452859899
Order product name	ST151T LED30S/930 WB BK
Order code	52859899
SAP numerator – quantity per pack	1
Numerator – packs per outer box	10
Material number (12NC)	911401846982
Net weight	0.510 kg
Full product name	ST151T LED30S/930 WB BK
EAN/UPC – Case	8719514528673



Dimensional drawing

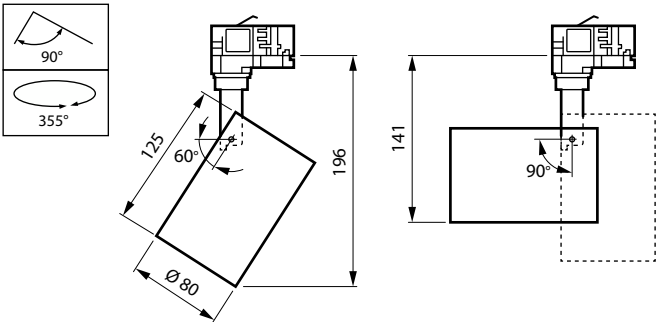

CoreLine Projector gen2

