

SARMA LED1X3100 D739 T830 R40 RAL9005 • 1024812

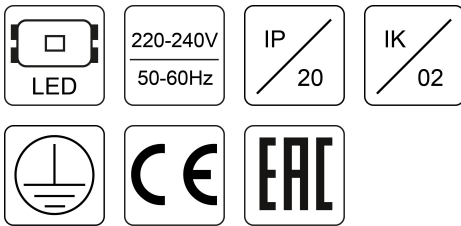

Product:	Sarma LED1x3100 D739 T830 R40 RAL9005
Order code:	1024812
Family:	Sarma LED
Product group:	Spotlights

GENERAL DATA

Description:	A cylindrical LED track light with symmetrical faceted reflector designed for the accent lighting Reflector: faceted aluminum, 40° (standard), 24° and 60° beam angles Diffuser: clear, PMMA Body: aluminum, white finish, with adaptor
Installation:	Surface luminaire is designed to be fixed into 4/6-conductors surface/recessed tracks. Track adaptor (3-phase + N) with phase selector
Environment	Indoor
Application	retail, public place, showroom, museum, exhibition

ELECTRICAL DATA

Mains voltage:	220-240V, 0/50/60Hz	System power*, W:	27.5
Power factor:	>0,95	Control gear:	ECG on/off
Connection:	Track adaptor (3-phase + N) with phase selector		

LIGHTING DATA

Light source and cap, W:	LED	Light source included:	yes
Luminaire output*, lm (ta+25°C):	3002	System efficacy, lm/W:	109
CRI (Ra):	80+	CCT, K:	3000
Distribution Type:	Direct	LED lifetime, h:	50000/L80B50

TECHNICAL DATA

Net weight, kg:	1.3	Quantity in package, pcs:	1
Packaging volume, m3/pcs:	0.0037584	Pallet quantity, pcs:	230

STANDARDS

Operating temperature range, °C:	ta 0...+35	Protection class IEC:	I
Ingress protection code:	IP20	Mechanical impact resistance:	IK02
EEC:	A++	Certificates:	CE, RoHS
Warranty:	3 years		

Technical drawing (.jpg)

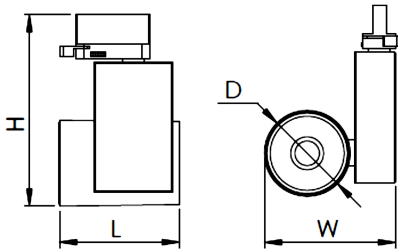

L, mm	W, mm	H, mm	D, mm
125	125	182	82
142	142	187	84

Light distribution curve (.jpg)

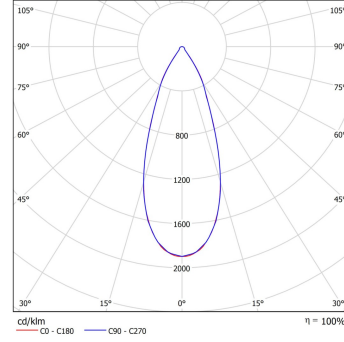

Date of issue: 2020-01-23 ■ NORTHCLIFFE LIGHTING, UAB ■ Raudondvario pl. 101, LT-47184 Kaunas, Lithuania ■ info@northcliffe.org ■ www.northcliffe.org